

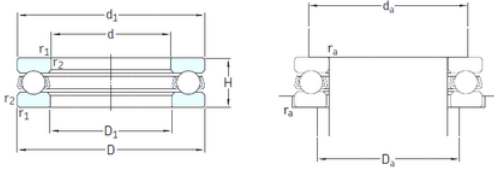

NTN Bearing Driveshaft do Brasil



SKF BA4 thrust ball bearings

Bearing No. BA4

Size	4x10x4 mm
Bore Diameter	4 mm
Outer Diameter	10 mm
Width	4 mm
d	4 mm
D	10 mm
H	4 mm
d1	9,8 mm
r1 min.	0,15 mm
r2 min.	0,15 mm
D1	4,2 mm
da min.	7,5 mm
Da max.	6,5 mm
ra max.	0,15 mm
Weight	0,0015 Kg
Basic dynamic load rating (C)	0,761 kN
Basic static load rating (C0)	0,72 kN
Fatigue load limit (Pu)	0,027
Reference speed	22000 r/min
Limiting speed	30000 r/min

BA4 Bearing 2D drawings and 3D CAD models