

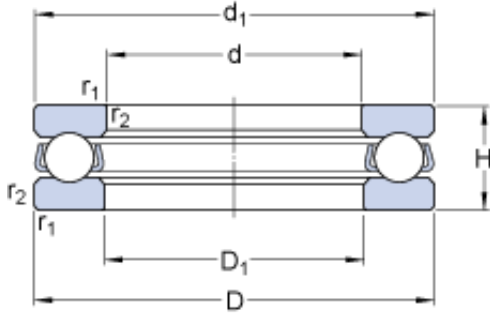

NTN Bearing Driveshaft do Brasil



511/800 F Bearing 2D drawings and 3D CAD models

SKF 511/800 F thrust ball bearings

Bearing No. 511/800 F

Size	950x800x120 mm
Bore Diameter	950 mm
Outer Diameter	800 mm
Width	120 mm
d	800 mm
D	950 mm
H	120 mm
d ₁	945 mm
D ₁	805 mm
r _{1,2} - min.	4 mm
d _a - min.	889 mm
D _a - max.	861 mm
r _a - max.	3 mm
Basic dynamic load rating - C	1010 kN
Basic static load rating - C ₀	9000 kN
Fatigue load limit - P _u	112 kN
Reference speed	340 r/min
Limiting speed	480 r/min
Minimum load factor - A	420
d ₁	945 mm
D ₁	805 mm
r _{1,2} min.	4 mm
d _a min.	889 mm
D _a max.	861 mm
r _a max.	3 mm



NTN Bearing Driveshaft do Brasil

Basic dynamic load rating C	1010 kN
Basic static load rating C_0	9000 kN
Fatigue load limit P_u	112 kN
Minimum load factor A	420
Mass bearing (including seat washer where applicable)	155 kg