

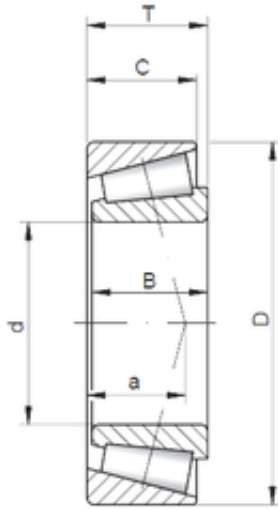

NTN Bearing Driveshaft do Brasil



165,1 mm x 288,925 mm x 63,5 mm 165,1 mm x
288,925 mm x 63,5 mm ISO HM237535/10
tapered roller bearings

Bearing No. HM237535/10

Size	165.1x288.925x63.5 mm
Bore Diameter	165,1 mm
Outer Diameter	288,925 mm
Width	63,5 mm
d	165,1 mm
D	288,925 mm
T	63,5 mm
B	63,5 mm
C	47,625 mm
a	11,7 mm

HM237535/10 Bearing 2D drawings and 3D CAD models