

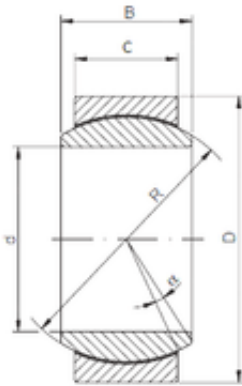

NTN Bearing Driveshaft do Brasil



12 mm x 22 mm x 10 mm 12 mm x 22 mm x 10 mm ISO GE 012 ECR plain bearings

Bearing No. GE 012 ECR

Size	12x22x10 mm
Bore Diameter	12 mm
Outer Diameter	22 mm
Width	10 mm
d	12 mm
D	22 mm
B	10 mm
C	7 mm
R	18 mm
Angle	11 °

GE 012 ECR Bearing 2D drawings and 3D CAD models