

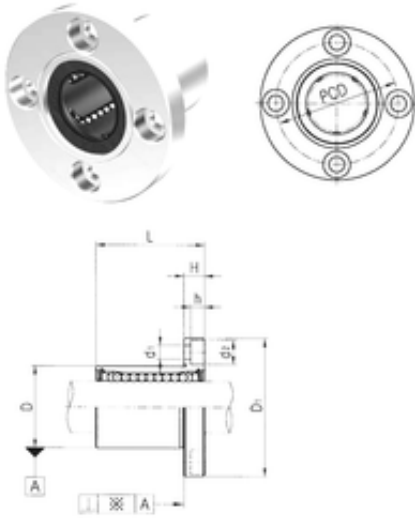

NTN Bearing Driveshaft do Brasil



LMEF50UU Bearing 2D drawings and 3D CAD models

Samick LMEF50UU linear bearings

Bearing No. LMEF50UU

Bore Diameter	50 mm
Outer Diameter	75 mm
d	50 mm
D	75 mm
d1	9 mm
d2	14 mm
h	8,6 mm
D1	112 mm
H	13 mm
L	100 mm
PCD	94 mm
Tolerance perpendicularity (C)	20
Weight	1,73 Kg
Basic dynamic load rating (C)	3,82 kN