

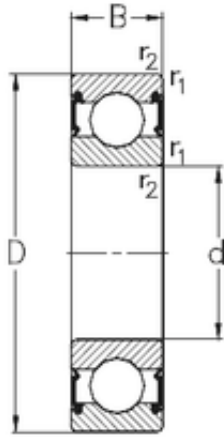

NTN Bearing Driveshaft do Brasil



45 mm x 100 mm x 25 mm 45 mm x 100 mm x 25 mm NKE 6309-RS2 deep groove ball bearings

Bearing No. 6309-RS2

Size	45x100x25 mm
Bore Diameter	45 mm
Outer Diameter	100 mm
Width	25 mm
d	45 mm
D	100 mm
B	25 mm
C	25 mm
r1 min.	1,5 mm
r2 min.	1,5 mm
Weight	0,848 Kg
Basic dynamic load rating (C)	53 kN
Basic static load rating (C0)	31,9 kN

6309-RS2 Bearing 2D drawings and 3D CAD models