

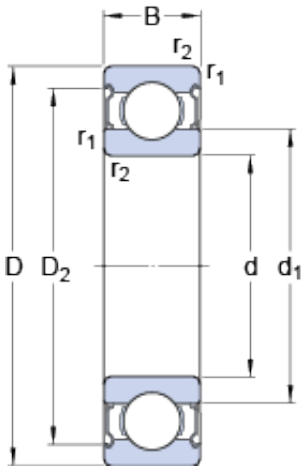

## NTN Bearing Driveshaft do Brasil



85 mm x 110 mm x 13 mm 85 mm x 110 mm x 13 mm SKF W 61817-2Z deep groove ball bearings

Bearing No. W 61817-2Z

W 61817-2Z Bearing 2D drawings and 3D CAD models

Size	110x85x13 mm
Bore Diameter	110 mm
Outer Diameter	85 mm
Width	13 mm
d	85 mm
D	110 mm
B	13 mm
d <sub>1</sub>	93 mm
D <sub>2</sub>	104.98 mm
r <sub>1,2</sub> - min.	1 mm
D <sub>a</sub> - max.	mm
r <sub>a</sub> - max.	1 mm
Basic dynamic load rating - C	16.3 kN
Basic static load rating - C <sub>0</sub>	20 kN
Fatigue load limit - P <sub>u</sub>	0.85 kN
Reference speed	12000 r/min
Limiting speed	6000 r/min
Calculation factor - k <sub>r</sub>	0.02
d <sub>1</sub>	93 mm
D <sub>2</sub>	104.98 mm
r <sub>1,2</sub> min.	1 mm
D <sub>a</sub> max.	0 mm
r <sub>a</sub> max.	1 mm
Basic dynamic load rating C	16.3 kN



## NTN Bearing Driveshaft do Brasil

Basic static load rating $C_0$	20 kN
Fatigue load limit $P_u$	0.85 kN
Calculation factor $k_r$	0.02
Calculation factor $f_0$	17.1